

## CS22U

2-Port USB VGA Cable KVM Switch with Remote Port Selector





# Simplify Your Desktop Workflows with KVM Agility

CS22U

2-Port USB VGA Cable  
KVM Switch with Remote  
Port Selector



The compact CS22U allows quick switching between 2 VGA-interfaced PCs via one KVM console and flexible media sharing via the console USB ports, which helps to expand desktop workspace while keeping it tidy and organized for improved productivity.



USB Peripheral



Bus-powered



Multi-platform  
Support

## Smooth Cross-Platform Integration

The CS22U enables the integration of different computer systems (Windows, Mac, Linux and Sun) that are accessible from one KVM console.





#### Flexible USB Peripheral Sharing

The console USB ports can be used for plug-n-play connection to compatible USB 2.0 peripheral devices to fulfill data-intensive desktop work requirements.

## Contact Us

Get a quote for this product or get in touch with our sales experts

Get Quote

[Contact Sales](#)**Plug in. Power on**

The CS22U supports USB hot-plugging and is bus-powered by the connected KVM sources via USB ports.

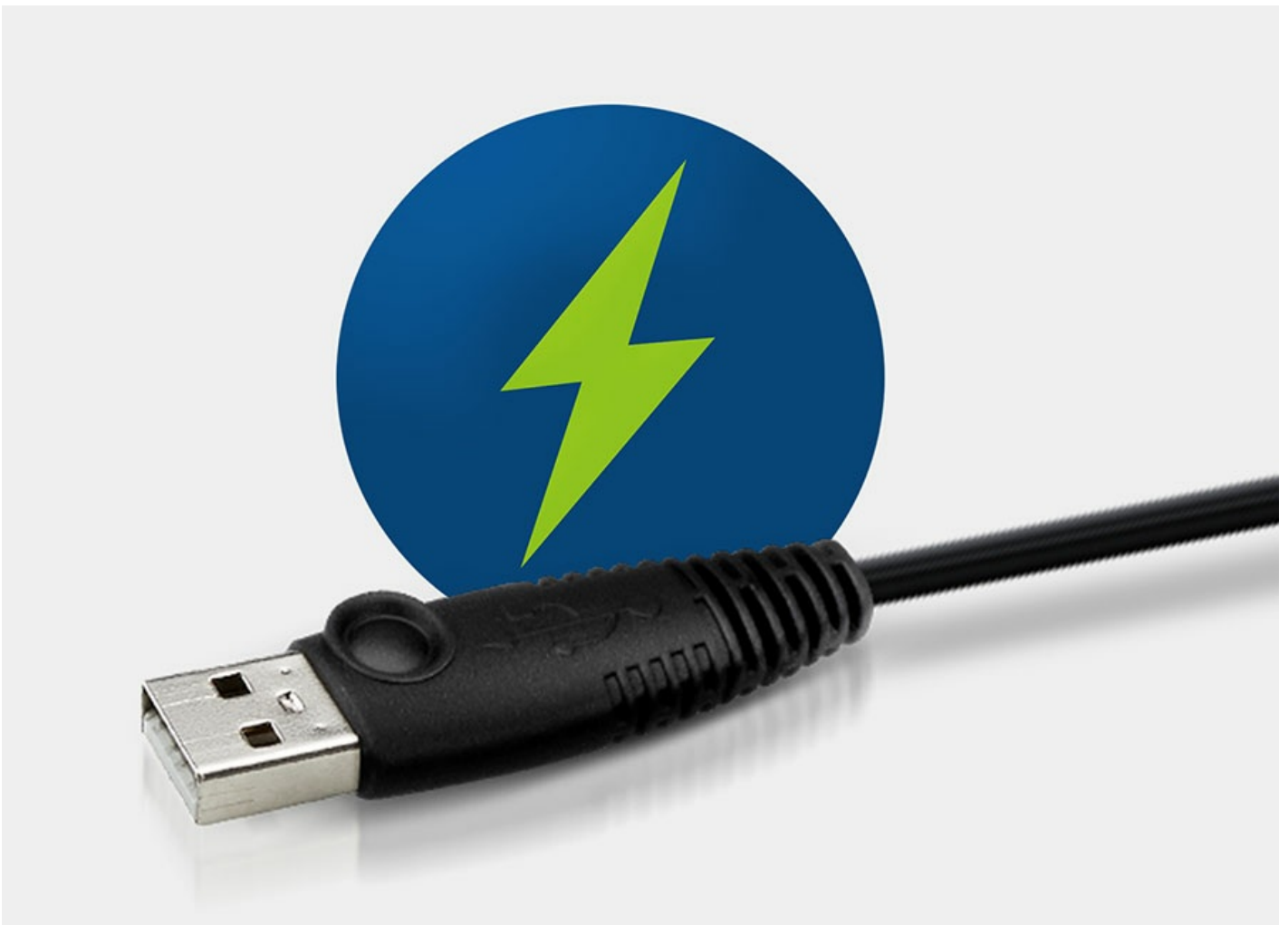
**Applications**





#### Product Comparison

## Talk to Our Experts

If you prefer to have ATEN contact you, please complete the form and a representative will be in touch with you shortly



First Name *
Last Name *
- Country *
Company *
Email *
Phone Number
- Customer Type *
Job Title *

## Features

The CS22U is a 2-port USB Cable KVM Switch that provides a simple and quick method of selecting computers - a built-in remote port selector. This allows the CS22U unit to be hidden from sight, while the remote port selector can be placed conveniently on the desktop.

The CS22U's compact all-in-one design makes it ideal for multiplatform desktop applications that require high resolution video.

- One USB console controls two USB computers
- Supports multifunction mice
- Multiplatform support - Windows, Mac, Linux and Sun
- The console USB ports can be used for USB peripheral sharing
- Superior video quality - up to 2048 x 1536; DDC2B
- Bus-Powered

## Specifications

Computer Connections	2
Port Selection	Remote Port Selector
Connectors	
Console Ports	1 x HDB-15 Female (Blue) 2 x USB Type A Female
KVM Ports	2 x HDB-15 Male (Blue) 4 x USB Type A Male (Black)
LEDs	
Selected	2
Cable Length	
Computer	2 x 0.9 m
Remote Port Selector	1.8 m
Video	2048 x 1536, DDC2B
Power Consumption	DC5V:0.14W:13BTU
Environmental	
Operating Temperature	0-50°C
Storage Temperature	-20-60°C
Humidity	0-80% RH, Non-condensing
Physical Properties	
Housing	Plastic
Weight	0.30 kg ( 0.66 lb )
Dimensions (L x W x H)	8.24 x 7.01 x 2.46 cm (3.24 x 2.76 x 0.97 in.)
Note	For some of rack mount products, please note that the standard physical dimensions of WxDxH are expressed using a LxWxH format.



## Diagram

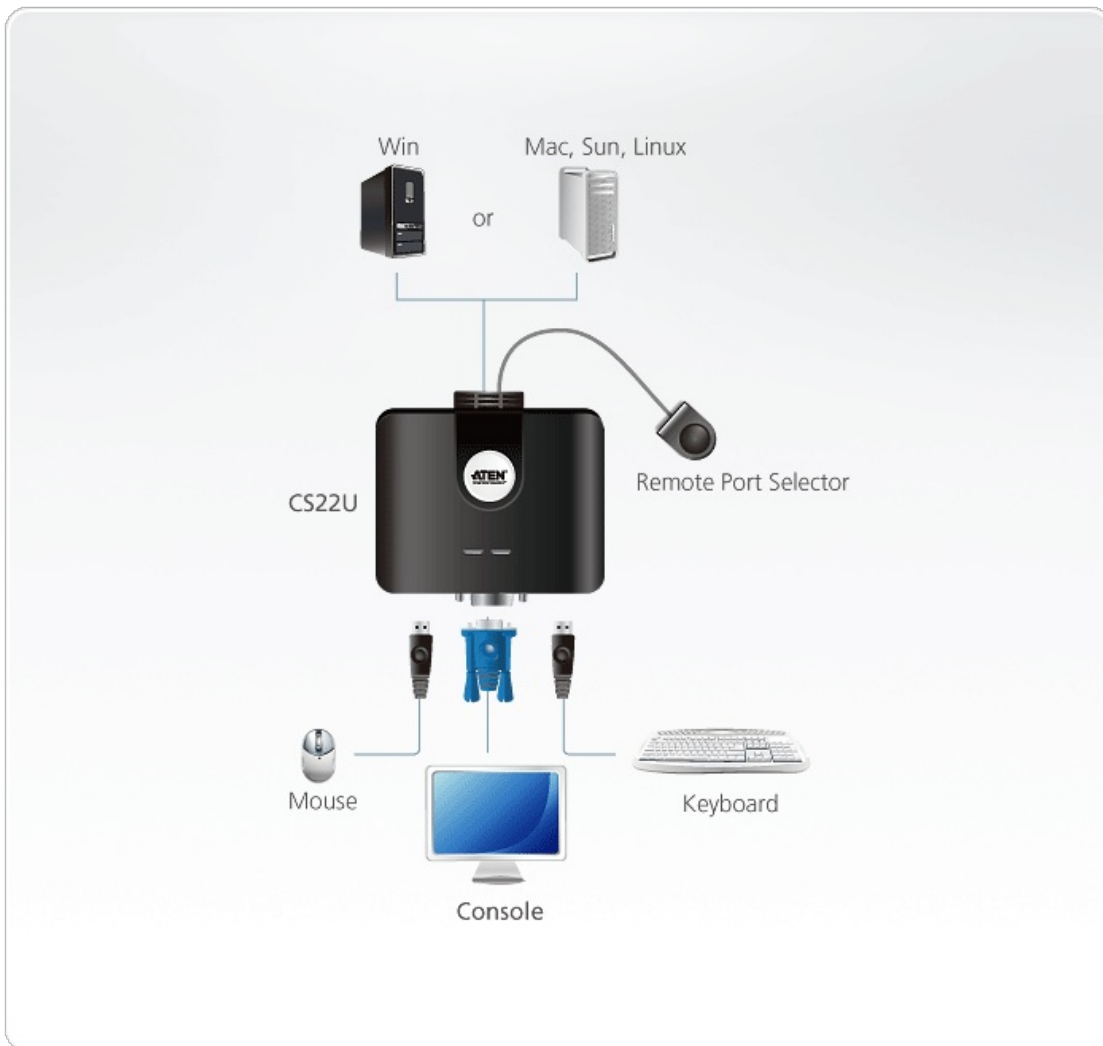

### **ATEN International Co., Ltd.**

3F., No.125, Sec. 2, Datong Rd., Sijhih District., New Taipei City 221, Taiwan  
 Phone: 886-2-8692-6789 Fax: 886-2-8692-6767  
 www.aten.com E-mail: marketing@aten.com



© Copyright 2015 ATEN® International Co., Ltd.  
 ATEN and the ATEN logo are trademarks of ATEN International Co., Ltd.  
 All rights reserved. All other trademarks are the property of their  
 respective owners.