

CE604

USB DVI Dual View Cat 5 KVM Extender (1024 x 768@60m)



The CE604 is a DVI Dual View USB based KVM Extender that features Dual View functionality, which enables the video output to seamlessly display on two monitors. With RS-232 serial functionality, it allows access to a computer system from a remote console up to 60 m away. The CE604 is built for control and security purposes, and is targeted towards financial and industrial markets.

The CE604 is equipped with an RS-232 serial channel that connects to a serial terminal or to serial devices, such as touch screens and barcode scanners. In addition, it supports an advanced PC Wake Up feature, which allows you to simply press a pushbutton from the remote dual view console to wake a PC at the local site. The CE604 eliminates the need for traveling back and forth between the local computer and remote console, making it an efficient and flexible solution.

The CE604 is ideal for applications that require the console to be in a conveniently accessible location, while the system equipment needs to reside in a safe place – away from dust, dirt and harsh environmental influences. It also provides a cost-effective way of keeping sensitive data, such as financial and personal information, safe in a heavily secured data center, while still allowing remote access to users.

Features

- Local and Remote Units connect at distances up to 60 m using two Cat 5e cables
- Transmit speaker, keyboard, mouse, DDC and one DVI via one Cat5 cable; RS-232, microphone and another DVI by adding a second Cat 5e cable
- Supports Dual View video source transmission (one PC with two video output ports)
- Audio Enabled – supports stereo speakers and microphone
- Supports Real DDC bypass and ATEN default EDID technology – set up various configurations via hotkeys
- Supports PC wakeup function via one pushbutton or hotkey
- RS-232 serial channel – connect to a serial terminal, or serial devices such as touchscreens and barcode scanners (Baud Rate up to 9600 bps)
- Compatible with other ATEN Dual View KVM devices, such as [CS1642A/ CS1644A](#) and [CS1762A/CS1764A](#)
- Superior video quality – up to 1920 x 1200 @ 60 Hz at 30 m; 1024 x 768 @ 60 Hz at 60 m
- Manual compensation control to adjust video signal quality in order to compensate for distance
- Built-in 8KV/15KV ESD protection (Contact voltage 8KV; Air voltage 15KV) and 2KV surge protection

Specifications

Function	CE604L	CE604R
Connectors		
Console Ports	N/A	2 x USB Type A Female (White) 2 x DVI-D Female (White) 1 x Mini Stereo Jack Female (Green) 1 x Mini Stereo Jack Female (Pink)

KVM Ports	1 x USB Type B Female (White) 1 x Mini Stereo Jack Female (Green) 1 x Mini Stereo Jack Female (Pink) 2 x DVI-D Female (White)	N/A
RS-232	1 x DB-9 Female (Black)	1 x DB-9 Male (Black)
Power	1 x DC Jack (Black)	1 x DC Jack (Black)
Sub / Main	2 x RJ-45 Female (Black)	2 x RJ-45 Female (Black)
LEDs		
Link	1 (Green)	1 (Green)
Power	1 (Green)	1 (Green)
Switches		
Picture Compensation	N/A	2 x 8-position switch
Firmware Upgrade	1 x Slide Switch	N/A
Pushbuttons		
Wakeup button	N/A	1 x pushbutton
Video	1920x1200 @ 60Hz (30 m); 1024x768 @ 60Hz (60 m)	1920x1200 @ 60Hz (30 m); 1024x768 @ 60Hz (60 m)
Power Consumption	DC5.3V:2.88W:18BTU/h Note: ● The measurement in Watts indicates the typical power consumption of the device with no external loading. ● The measurement in BTU/h indicates the power consumption of the device when it is fully loaded.	DC5.3V:2.35W:15BTU/h Note: ● The measurement in Watts indicates the typical power consumption of the device with no external loading. ● The measurement in BTU/h indicates the power consumption of the device when it is fully loaded.
Environmental		
Operating Temperature	0–50°C	0–50°C
Storage Temperature	-20–60°C	-20–60°C
Humidity	0–80% RH, Non-condensing	0–80% RH, Non-condensing
Physical Properties		
Housing	Metal	Metal
Weight	0.49 kg (1.08 lb)	0.49 kg (1.08 lb)
Dimensions (L x W x H)	20.20 x 8.53 x 2.50 cm (7.95 x 3.36 x 0.98 in.)	20.20 x 8.67 x 2.50 cm (7.95 x 3.41 x 0.98 in.)
Note	For some of rack mount products, please note that the standard physical dimensions of WxDxH are expressed using a LxWxH format.	

Diagram

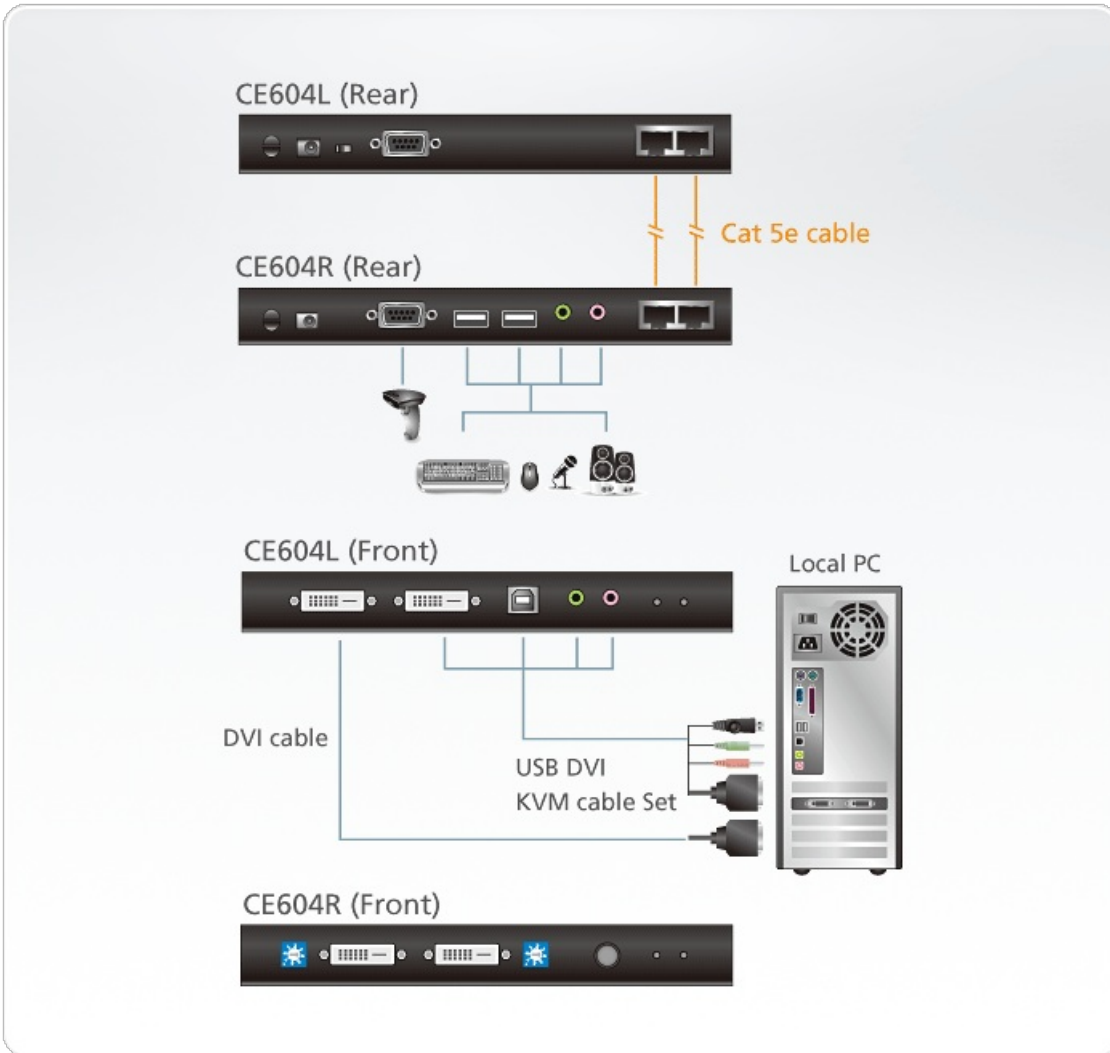

ATEN International Co., Ltd.

3F., No.125, Sec. 2, Datong Rd., Sijhih District., New Taipei City 221, Taiwan
 Phone: 886-2-8692-6789 Fax: 886-2-8692-6767
 www.aten.com E-mail: marketing@aten.com



© Copyright 2015 ATEN® International Co., Ltd.
 ATEN and the ATEN logo are trademarks of ATEN International Co., Ltd.
 All rights reserved. All other trademarks are the property of their
 respective owners.