

2A-130G

VGA EDID Emulator



The 2A-130G VGA EDID Emulator is designed for ATEN KVM extender or video extender installations that do not utilize a local monitor at the site where the computer/video source is located. The 2A-130G emulates and stores a default ATEN EDID (Extended Display Identification Information) setting in a non-volatile memory. This means the computer/video source can still "see" the display, even though it is not directly connected. The 2A-130G is suitable for any ATEN KVM or video extender installation where a monitor is not required at the local site, providing a simple, cost-saving, and convenient solution for display-related boot-up problems.

Features

- [Substitutes as a monitor at the site where the computer/video source is located](#)
- [EDID built-in - Stores ATEN standard EDID information in device](#)
- ATEN standard EDID supports all popular resolutions
- Superior video quality - up to 1920 x 1200@60Hz, 1366 x 768@60Hz
- [USB Powered - No need for an external power adapter](#)
- No software required - Eliminates incompatibility and installation issues; no need to configure
- [Compatible Extenders: CE774, CE775, CE700A, CE750, CE770, CE800B, CE350, CE370, CE250A, CE252, VE150A, VE170, VE200, VE300, VE500](#)
- [Compatible Splitters \(Connect to Port 1\): VS132A/134A/138A, VS92A/94A/98A, VS82/84/88, VS0116, VS132, VS102, VS1204T, VS1208T, VS1504, VS1508](#)
- [Supported Resolutions](#)

Specifications

Connectors	
Video	1 x HDB-15 Male (Blue)
Power	1 x USB Type A Male
LEDs	
Power	1 (Green)
Video	1920 x 1200@60Hz 1366 x 768@60Hz
Cable Length	0.35 m
Power Consumption	DC5V:0.1W:1BTU/h Note: <ul style="list-style-type: none"> ● The measurement in Watts indicates the typical power consumption of the device with no external loading. ● The measurement in BTU/h indicates the power consumption of the device when it is fully loaded.
Environmental	
Operating Temperature	0-50°C
Storage Temperature	-20-60°C
Humidity	0-80% RH, Non-condensing
Physical Properties	
Housing	Plastic

Diagram

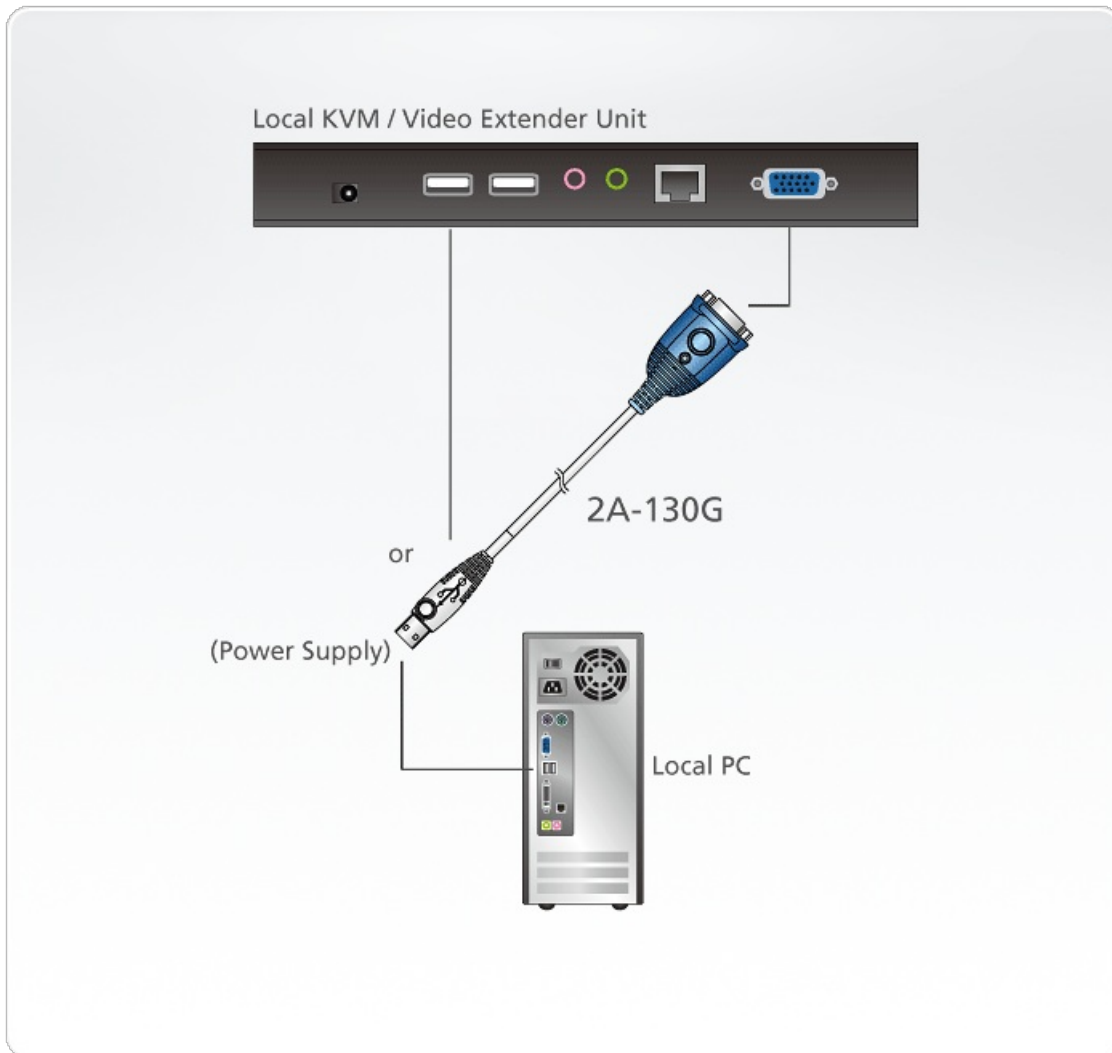

ATEN International Co., Ltd.

3F., No.125, Sec. 2, Datong Rd., Sijhih District., New Taipei City 221, Taiwan
 Phone: 886-2-8692-6789 Fax: 886-2-8692-6767
 www.aten.com E-mail: marketing@aten.com



© Copyright 2015 ATEN® International Co., Ltd.
 ATEN and the ATEN logo are trademarks of ATEN International Co., Ltd.
 All rights reserved. All other trademarks are the property of their
 respective owners.