

CE620

USB DVI HDBase™ 2.0 KVM Extender (Long Reach mode up to 1920 x 1080@150 m)



The ATEN CE620 USB DVI HDBase™ 2.0 KVM Extender integrates the latest HDBase™ 2.0 technologies to provide the most reliable transmission of video, audio, USB and RS-232 signals available on the market. Featured with a Long Reach mode, the CE620 delivers high-quality DVI video, PCM 2-channel digital audio, USB 2.0, and RS-232 signals up to 150 meters using a single Cat6/6a/ATEN [2L-2910](#) Cat 6 cable. With a simple cable installation supporting various signals, the CE620 is ideal for applications where convenient remote access is required – in places such as transportation control centers, medical facilities, industrial warehouses and extended workstations.



Features

- HDBase™ 2.0 connectivity technology
 - Extends video, audio, USB and RS-232 signals via a single Ethernet cable
 - EDID Buffer for smooth power-up and the highest quality display
 - Enhanced bit error detection and correction to resist signal interference during high-quality video transmissions
 - Long distance superior video quality
 - HDBase™ Standard mode up to 1920 x 1200 @ 100 m
 - HDBase™ Long Reach mode up to 1920 x 1080 @ 150 m
 - Long Reach mode switch — switches between HDBase™ Standard and Long Reach modes in a snap
 - Integrated USB 2.0 ports — ensuring fast transmission speeds for peripherals
 - Supports 2-channel PCM digital audio — ensuring highquality audio transmissions
 - Supports PC Wakeup function via pushbutton or hotkey
 - Built-in 8KV/15KV ESD protection (Contact voltage 8KV; Air voltage 15KV)
- Note: The CE620 does not support HDCP.

Specification

Function	CE620L	CE620R
Connectors		
KVM Ports	1 x DVI-D Female (White) 1 x USB Type B Female (White) 1 x Mini Stereo Jack Female (Green) 1 x Mini Stereo Jack Female (Pink)	N/A

Console Ports	N/A	1 x DVI-D Female (White) 3 x USB Type A Female 1 x Mini Stereo Jack Female (Green) 1 x Mini Stereo Jack Female (Pink)
RS-232	1 x DB-9 Female (Black)	1 x DB-9 Male (Black)
Power	1 x DC Jack with locking	1 x DC Jack with locking
Unit To Unit	1 x RJ-45 Female (Black)	1 x RJ-45 Female (Black)
LEDs		
Power	1 (Green)	1 (Green)
Link	1 (Orange)	1 (Orange)
Video Output	N/A	1 (Orange)
Switches		
Long Reach Mode Switch	1 x Slide Switch	1 x Slide Switch
Firmware Upgrade	1 x Slide Switch	1 x Slide Switch
Pushbuttons		
Wakeup button	N/A	1 x Push button
Video	Up to 1600x1200 & 1920x1200@90m (Cat 5e) / 100m (cat 6/6a) 1920x1080@150m (Long reach mode enable)	Up to 1600x1200 & 1920x1200@90m (Cat 5e) / 100m (cat 6/6a) 1920x1080@150m (Long reach mode enable)
Power Consumption	DC5V:2.68W:13BTU	DC5V:5.02W:28BTU
Environmental		
Operating Temperature	0–40°C	0–40°C
Storage Temperature	-20–60°C	-20–60°C
Humidity	0–80% RH, Non-condensing	0–80% RH, Non-condensing
Physical Properties		
Housing	Metal	Metal
Weight	0.63 kg (1.39 lb)	0.64 kg (1.41 lb)
Dimensions (L x W x H)	18.20 x 12.28 x 2.87 cm (7.17 x 4.83 x 1.13 in.)	18.20 x 12.28 x 2.87 cm (7.17 x 4.83 x 1.13 in.)
Note	For some of rack mount products, please note that the standard physical dimensions of WxDxH are expressed using a LxWxH format.	

Diagram

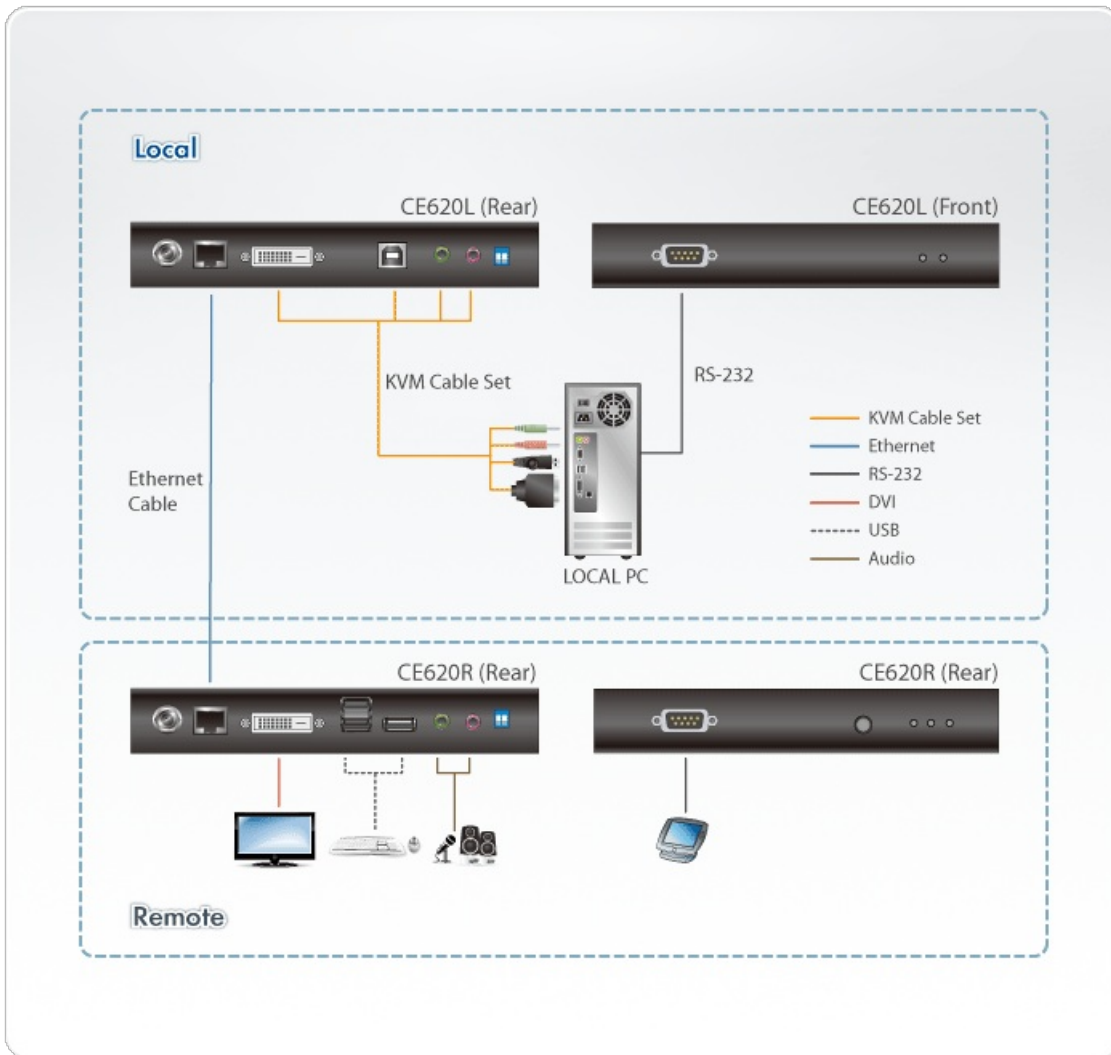

ATEN International Co., Ltd.

3F., No.125, Sec. 2, Datong Rd., Sijhih District., New Taipei City 221, Taiwan
 Phone: 886-2-8692-6789 Fax: 886-2-8692-6767
 www.aten.com E-mail: marketing@aten.com



© Copyright 2015 ATEN® International Co., Ltd.
 ATEN and the ATEN logo are trademarks of ATEN International Co., Ltd.
 All rights reserved. All other trademarks are the property of their respective owners.