

VE157

VGA/Audio Cat 5 Extender with MK Wall Plate (1280 x 1024 @150 m)



The VE157 VGA/Audio Cat 5 Extender with MK Wall Plate is designed to be conveniently mounted in a one- gang junction box for UK, Singapore, Hong Kong and other markets that apply MK type junction boxes. It extends VGA and audio signals up to 150 meters over a Cat 5e/6 cable and supports wide screen formats while ensuring excellent video quality.

The VE157 can be easily powered at either the Transmitter or Receiver side using another Cat 5e/6 cable. The VE157's compact wall plate design does away with bulky cables allowing a neat and convenient installation. Therefore, it is a perfect solution for function rooms, museums and any setting that requires equipment or cabling to be kept from the public's view.

Features

- Uses two Cat 5e/6 cables to connect the local and remote units- one to transmit video, and another for power*
- Remotely powered from either the Transmitter or Receiver side**
- Extends the distance between VGA source and VGA display
- Supports superior video quality up to 1920 x 1200 @60 Hz at a distance of 30 m; 1280 x 1024 @ 60 Hz at a distance of 150 m
- Designed to mount in one- gang junction box for UK, Singapore, Hong Kong and other markets that apply MK type junction boxes.
- Adjustable Gain Control – manually adjusts signal strength to compensate for distance
- Supports wide screen formats
- Supports hot- plugging
- Supports stereo audio
- Built- in 8KV/ 15 KV ESD protection
- Plug- and- play with no software installation required
- LED indication of power sources / connection status

* A second Cat 5e/6 cable connection is required to remotely power on either the transmitter or receiver

**A power adapter is provided with this package and can be used at either the transmitter or receiver side, which in turn remotely powers the other unit

Specifications

Function	VE157R	VE157T
Video Input		
Interfaces	N/A	1 x HDB-15 Female (Blue)
Impedance	N/A	100 Ω
Video Output		
Interfaces	1 x HDB-15 Female (Blue)	N/A

Impedance	100 Ω	N/A
Video		
Max. Resolutions / Distance	Up to 1920 x 1200@30m; 1280 x 1024@150m	Up to 1920 x 1200@30m; 1280 x 1024@150m
Max. Bandwidth	300 MHz	300 MHz
Audio		
Input	N/A	1 x Mini Stereo Jack Female (Green)
Output	1 x Mini Stereo Jack Female (Green)	N/A
Connectors		
Power	1 x Terminal Block (Green)	1 x Terminal Block (Green)
Power Consumption	DC9V:0.95W:4BTU/h Note: ● The measurement in Watts indicates the typical power consumption of the device with no external loading. ● The measurement in BTU/h indicates the power consumption of the device when it is fully loaded.	DC9V:1.65W:8BTU/h Note: ● The measurement in Watts indicates the typical power consumption of the device with no external loading. ● The measurement in BTU/h indicates the power consumption of the device when it is fully loaded.
Environmental		
Operating Temperature	0 - 50°C	0 - 50°C
Storage Temperature	-20 - 60°C	-20 - 60°C
Humidity	0 - 80% RH, Non-Condensing	0 - 80% RH, Non-Condensing
Physical Properties		
Housing	Metal	Metal
Weight	0.18 kg (0.4 lb)	0.18 kg (0.4 lb)
Dimensions (L x W x H)	6.86 x 4.44 x 4.28 cm (2.7 x 1.75 x 1.69 in.)	6.86 x 4.44 x 4.28 cm (2.7 x 1.75 x 1.69 in.)
Faceplate Dimensions (L x W x H)	8.60 x 8.60 x 1.60 cm (3.39 x 3.39 x 0.63 in.)	8.60 x 8.60 x 1.60 cm (3.39 x 3.39 x 0.63 in.)
Carton Lot	5 pcs	5 pcs
Note	For some of rack mount products, please note that the standard physical dimensions of WxDxH are expressed using a LxWxH format.	

Diagram

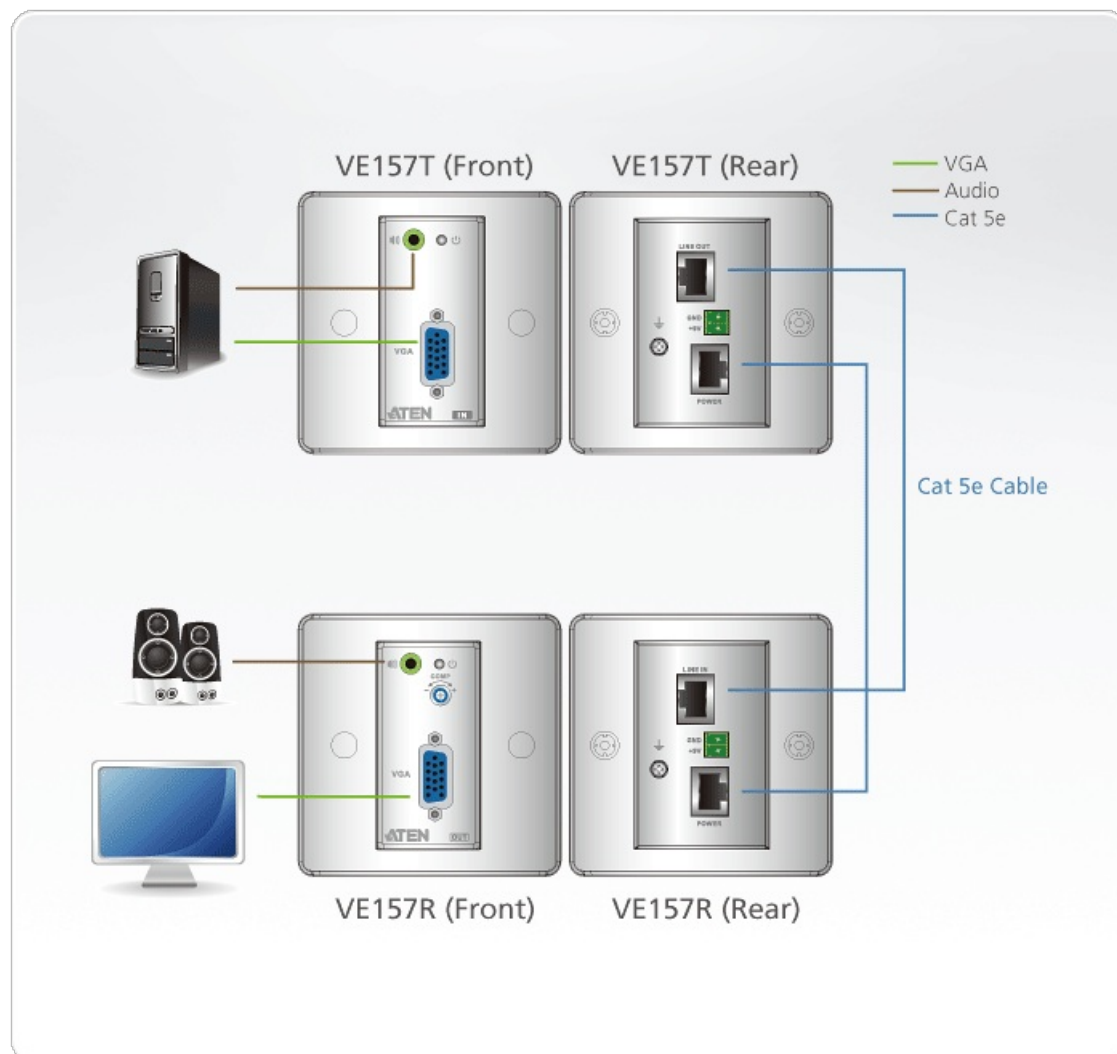

ATEN International Co., Ltd.

3F., No.125, Sec. 2, Datong Rd., Sijhih District., New Taipei City 221, Taiwan
 Phone: 886-2-8692-6789 Fax: 886-2-8692-6767
 www.aten.com E-mail: marketing@aten.com



© Copyright 2015 ATEN® International Co., Ltd.
 ATEN and the ATEN logo are trademarks of ATEN International Co., Ltd.
 All rights reserved. All other trademarks are the property of their
 respective owners.