

CE611

Mini USB DVI HDBaseT™ KVM Extender (1920 x 1200@100m)



The ATEN CE611 is a USB DVI HDBaseT™ KVM Extender that integrates the latest HDBaseT™ technologies to transmit 1920 x 1200 DVI video, stereo audio, USB, and RS-232 signals up to 100 meters using a single Cat6 / 6a cable / ATEN [2L-2910](#) Cat 6 cable. This cost-effective extender comes with a small form factor design that includes DVI/audio interfaces, USB 2.0 full-speed ports, and serial console to fulfill most of extended KVM control and console demands. With an easy cable installation that supports various signals, the CE611 is ideal for applications where convenient remote access is required, such as transportation control centers, medical facilities, industrial warehouses, and extended workstations.



Features

- Supports HDBaseT™ technology
 - Extends video, audio, USB, and RS-232 signals via a single Cat6 / 6a / ATEN [2L-2910](#) Cat 6 cable
 - Enhanced bit error detection and correction to resist signal interference during high-quality video transmissions
 - Status detection and LED indication for HDBaseT™ signal transmission
- Long distance with superior video quality – up to 1920 x 1200 @ 100m (Cat6 / 6a cable / ATEN [2L-2910](#) Cat 6 cable)
- USB 2.0 full speed ports – ensures fast transmission speeds for peripherals
- Supports individual 2-channel stereo audio for high-quality audio applications
- Built-in 8KV / 15KV ESD protection (contact voltage 8KV; air voltage 15KV)

Specification

Function	CE611L	CE611R
Connectors		
KVM Ports	1 x DVI-D Female (White) 1 x USB Type B Female (White) 1 x Mini Stereo Jack Female (Green) 1 x Mini Stereo Jack Female (Pink)	N/A
Console Ports	N/A	1 x DVI-D Female (White) 2 x USB Type A Female 1 x Mini Stereo Jack Female (Green) 1 x Mini Stereo Jack Female (Pink)
RS-232	1 x DB-9 Female (Black); Type: DTE	1 x DB-9 Male (Black); Type: DTE

Power	1 x DC Jack with locking	1 x DC Jack with locking
Unit To Unit	1 x RJ-45 Female (Black)	1 x RJ-45 Female (Black)
LEDs		
Power	1 (Green)	1 (Green)
Link	1 (Orange)	1 (Orange)
Video Output	N/A	1 (Orange)
Switches		
Firmware Upgrade	1 x Slide Switch	1 x Slide Switch
Video	Up to 1600x1200 & 1920x1200@90m (Cat 5e) / 100m (Cat 6/6a/ATEN 2L-2910 Cat6) 1920x1080@100m(Cat 5e/6/6a)	Up to 1600x1200 & 1920x1200@90m (Cat 5e) / 100m (Cat 6/6a/ATEN 2L-2910 Cat6) 1920x1080@100m(Cat 5e/6/6a)
Power Consumption	DC5V: 2.494W:16BTU/h Note: ● The measurement in Watts indicates the typical power consumption of the device with no external loading. ● The measurement in BTU/h indicates the power consumption of the device when it is fully loaded.	DC5V: 4.816W:27BTU/h Note: ● The measurement in Watts indicates the typical power consumption of the device with no external loading. ● The measurement in BTU/h indicates the power consumption of the device when it is fully loaded.
Environmental		
Operating Temperature	0–40°C	0–40°C
Storage Temperature	-20–60°C	-20–60°C
Humidity	0–80% RH, Non-condensing	0–80% RH, Non-condensing
Physical Properties		
Housing	Metal	Metal
Weight	0.35 kg (0.77 lb)	0.34 kg (0.75 lb)
Dimensions (L x W x H)	12.80 x 8.69 x 2.50 cm (5.04 x 3.42 x 0.98 in.)	12.80 x 8.69 x 2.50 cm (5.04 x 3.42 x 0.98 in.)
Note	For some of rack mount products, please note that the standard physical dimensions of WxDxH are expressed using a LxWxH format.	

Diagram

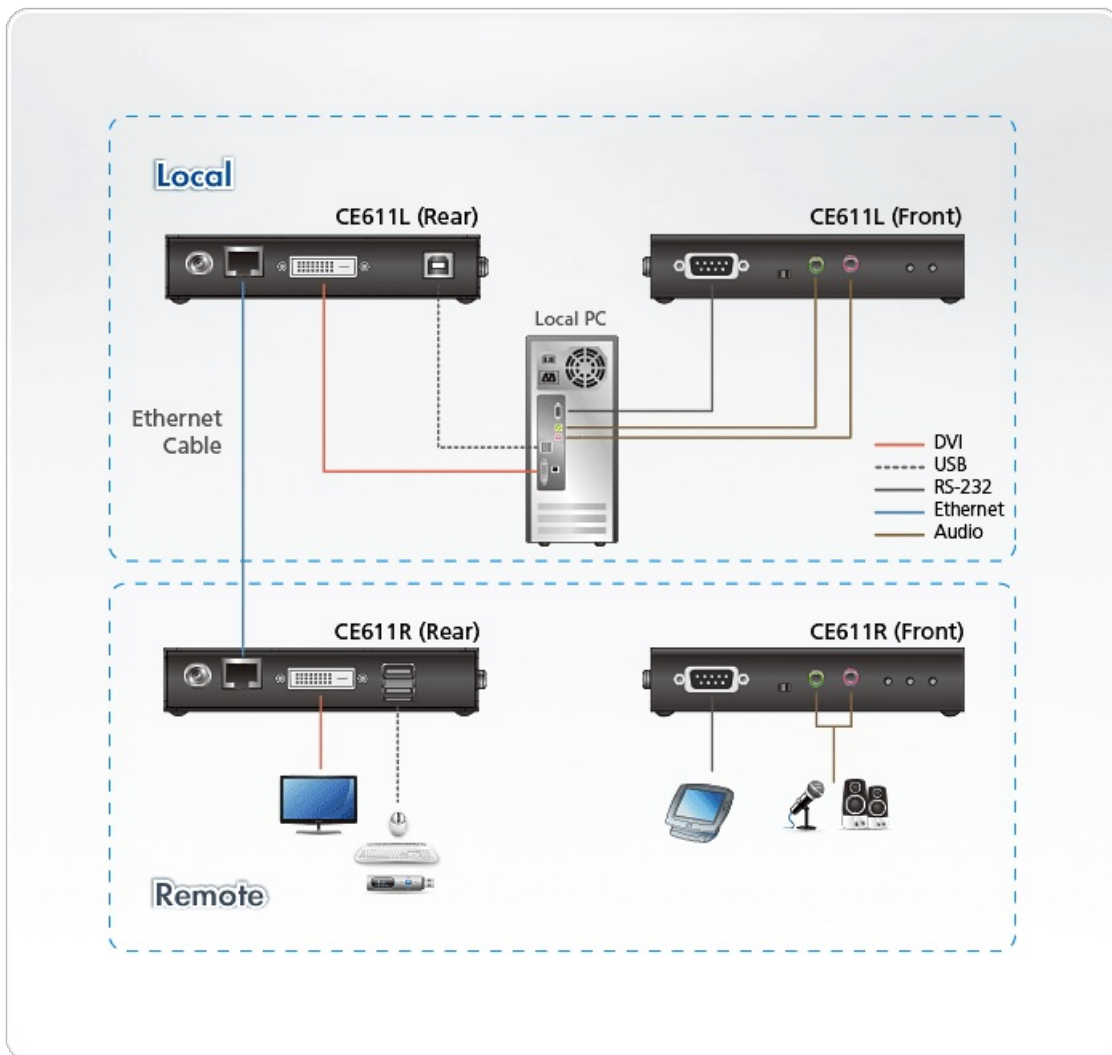

ATEN International Co., Ltd.

3F., No.125, Sec. 2, Datong Rd., Sijhih District., New Taipei City 221, Taiwan
 Phone: 886-2-8692-6789 Fax: 886-2-8692-6767
 www.aten.com E-mail: marketing@aten.com



© Copyright 2015 ATEN® International Co., Ltd.
 ATEN and the ATEN logo are trademarks of ATEN International Co., Ltd.
 All rights reserved. All other trademarks are the property of their respective owners.