

UCE260

USB 2.0 Cat 5 Extender (up to 60m)



UCE260 can easily send the USB signals via Cat.5/5e/6 cable up to 60 meters (196 ft) at data rate of High Speed (480Mb/s) , Full Speed (12Mb/s) and Low Speed (1.5Mb/s). Without any configuration or software driver, this USB extender allows you to extend your USB device or hub up to 60m from your computer, which overcomes the typical USB cable limitation.



Features

- Supports any High-Speed (480Mb/s), full-speed (12 Mb/s) or low-speed (1.5 Mb/s) USB devices
- Extends signal transmission distance of a USB devices up to 60m via a Cat 5/5e/6 cable
- Includes an AC adapter to stabilize power supply
- Hot-Pluggable
- The most cost-effective USB extender solution
- No additional software driver required

Specification

USB 2.0 Extender

Function	Local Unit	Remote Unit
Connectors		
USB Port	1 x USB Type A Male	1 x USB Type A Female
Link	1 x RJ45 Female	1 x RJ45 Female
Power	N/A	1 x DC Power Jack
USB Specification	2.0 For High / Full / Low Speed	2.0 For High / Full / Low Speed
USB Devices Supported	N/A	1 Device
Power Consumption	Bus-Powered	Self-Powered, 5V, 13W
Environmental		
Operating Temperature	0–40°C	0–40°C
Storage Temperature	-20–60°C	-20–60°C
Humidity	0–80% RH, Non-condensing	0–80% RH, Non-condensing
Physical Properties		
Housing	Plastic	Plastic
Weight	0.04 kg (0.09 lb)	0.02 kg (0.05 lb)
Dimensions (L x W x H)	6.30 x 3.10 x 2.19 cm (2.48 x 1.22 x 0.86 in.)	6.30 x 3.10 x 2.19 cm (2.48 x 1.22 x 0.86 in.)
Note	For some of rack mount products, please note that the standard physical dimensions of WxDxH are expressed using a LxWxH format.	

Diagram

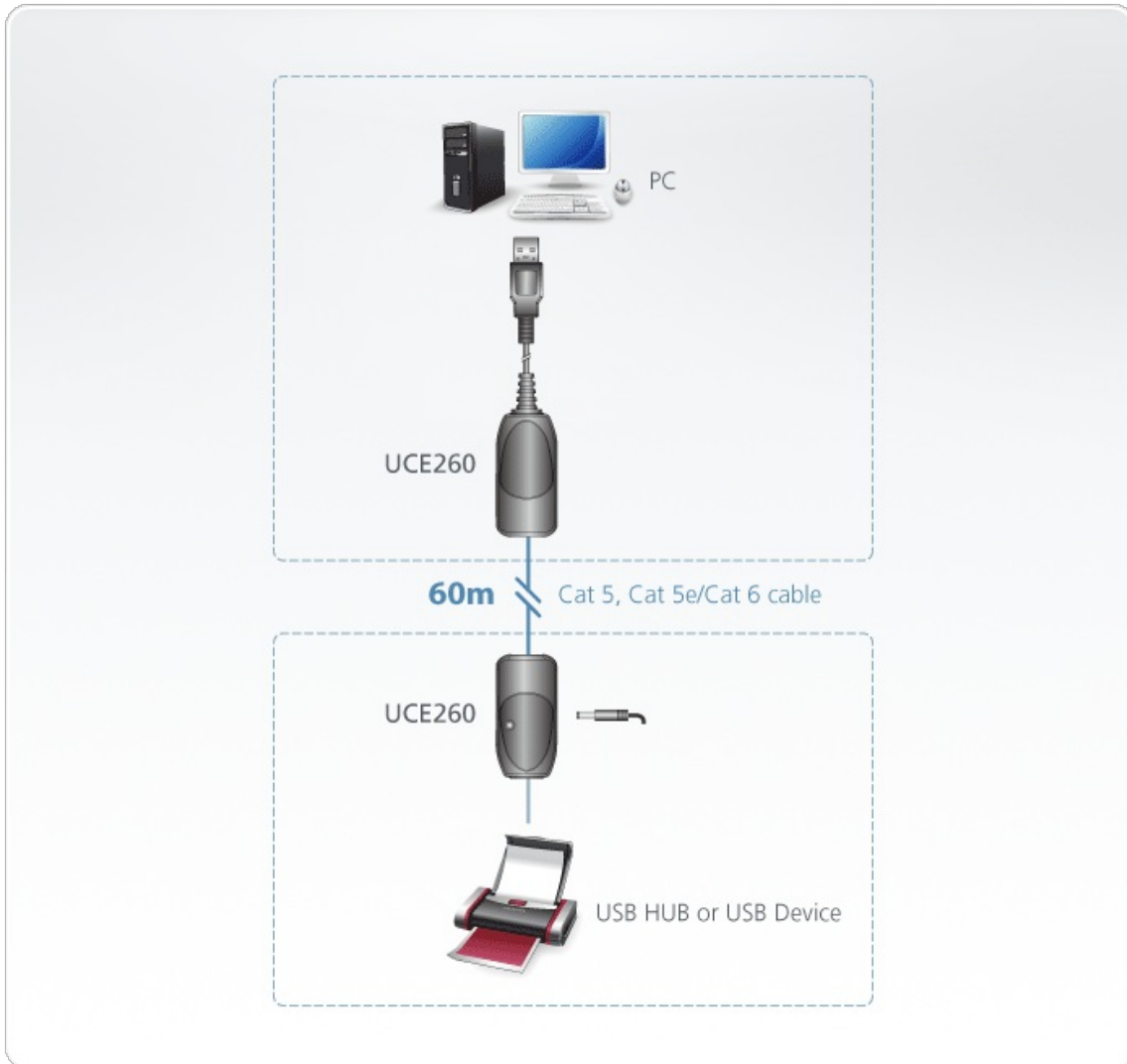

ATEN International Co., Ltd.

3F., No.125, Sec. 2, Datong Rd., Sijhih District., New Taipei City 221, Taiwan
Phone: 886-2-8692-6789 Fax: 886-2-8692-6767
www.aten.com E-mail: marketing@aten.com



© Copyright 2015 ATEN® International Co., Ltd.
ATEN and the ATEN logo are trademarks of ATEN International Co., Ltd.
All rights reserved. All other trademarks are the property of their respective owners.