

## VE607

DVI/Audio Cat 5 Extender with MK Wall Plate (1920 x 1200 @ 40m)



The VE607 DVI/Audio Cat 5 Extender with MK Wall Plate is designed to be conveniently mounted in a one-gang junction box for UK, Singapore, Hong Kong and other markets that apply MK type junction boxes. It extends DVI and audio signals up to 60 m over Cat 5e/6 cable and supports wide screen formats while ensuring excellent video quality.

The VE607 can be easily powered at either the transmitter or receiver side using a second Cat 5e/6 cable. The VE607's compact wall plate design does away with bulky cables allowing a neat and convenient installation. Therefore, it is a perfect solution for function rooms, museums and any setting that requires equipment or cabling to be kept from the public's view.

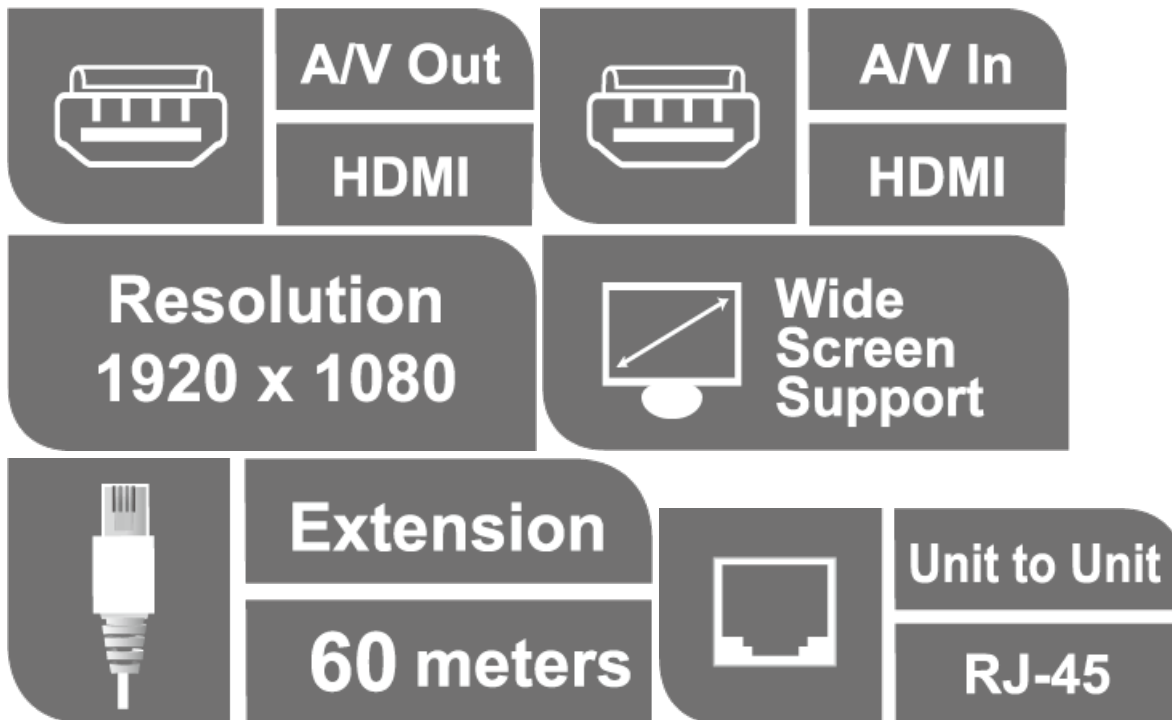

## Features

- Uses two Cat 5e/6 cables to connect the local and remote units- one to transmit video, and another for power\*
- Remotely powered from either the transmitter or receiver side\*\*
- Extends the distance between DVI source and DVI display
- Superior video quality – up to 1920 x 1200@40m; 1280 x 1024@60m
- Designed to mount in one- gang junction box for UK, Singapore, Hong Kong and other markets that apply MK type junction boxes.
- Supports 8 segment equalization adjustment via switch
- Supports wide screen formats
- Supports hot- plugging
- Supports stereo audio
- Built- in 8KV/ 15 KV ESD protection
- Plug- and- play with no software installation required
- LED indication of power sources / connection status

\* A second Cat 5e/6 cable connection is required to remotely power on either the transmitter or receiver

\*\* A power adapter is provided with this package and can be used at either the transmitter or receiver side, which in turn remotely powers the other unit

## Specifications

Function	VE607R	VE607T
Video Input		
Interfaces	N/A	1 x DVI-D Female (White)
Impedance	N/A	100 Ω
Video Output		
Interfaces	1 x DVI-D Female (White)	N/A
Impedance	100 Ω	N/A
Video		
Max. Data Rate	6.75 Gbps (2.25 Gbps Per Lane)	6.75 Gbps (2.25 Gbps Per Lane)
Max. Pixel Clock	225 MHz	225 MHz
Compliance	HDCP Compatible	HDCP Compatible
Max. Resolutions / Distance	Up to 1920 x 1200@40m; 1280 x 1024@60m	Up to 1920 x 1200@40m; 1280 x 1024@60m
Audio		
Input	N/A	1 x Mini Stereo Jack Female (Green)
Output	1 x Mini Stereo Jack Female (Green)	N/A
Connectors		
Power	1 x Terminal Block (Green)	1 x Terminal Block (Green)
Power Consumption	DC9V:0.81W:4BTU/h  Note: ● The measurement in Watts indicates the typical power consumption of the device with no external loading. ● The measurement in BTU/h indicates the power consumption of the device when it is fully loaded.	DC9V:1.35W:6BTU/h  Note: ● The measurement in Watts indicates the typical power consumption of the device with no external loading. ● The measurement in BTU/h indicates the power consumption of the device when it is fully loaded.

Environmental		
Operating Temperature	0 - 50°C	0 - 50°C
Storage Temperature	-20 - 60°C	-20 - 60°C
Humidity	0 - 80% RH, Non-Condensing	0 - 80% RH, Non-Condensing
Physical Properties		
Housing	Metal	Metal
Weight	0.18 kg ( 0.4 lb )	0.18 kg ( 0.4 lb )
Dimensions (L x W x H)	6.86 x 4.44 x 4.34 cm (2.7 x 1.75 x 1.71 in.)	6.86 x 4.44 x 4.34 cm (2.7 x 1.75 x 1.71 in.)
Faceplate Dimensions (L x W x H)	8.60 x 8.60 x 1.60 cm (3.39 x 3.39 x 0.63 in.)	8.60 x 8.60 x 1.60 cm (3.39 x 3.39 x 0.63 in.)
Carton Lot	5 pcs	5 pcs
Note	For some of rack mount products, please note that the standard physical dimensions of WxDxH are expressed using a LxWxH format.	

# Diagram

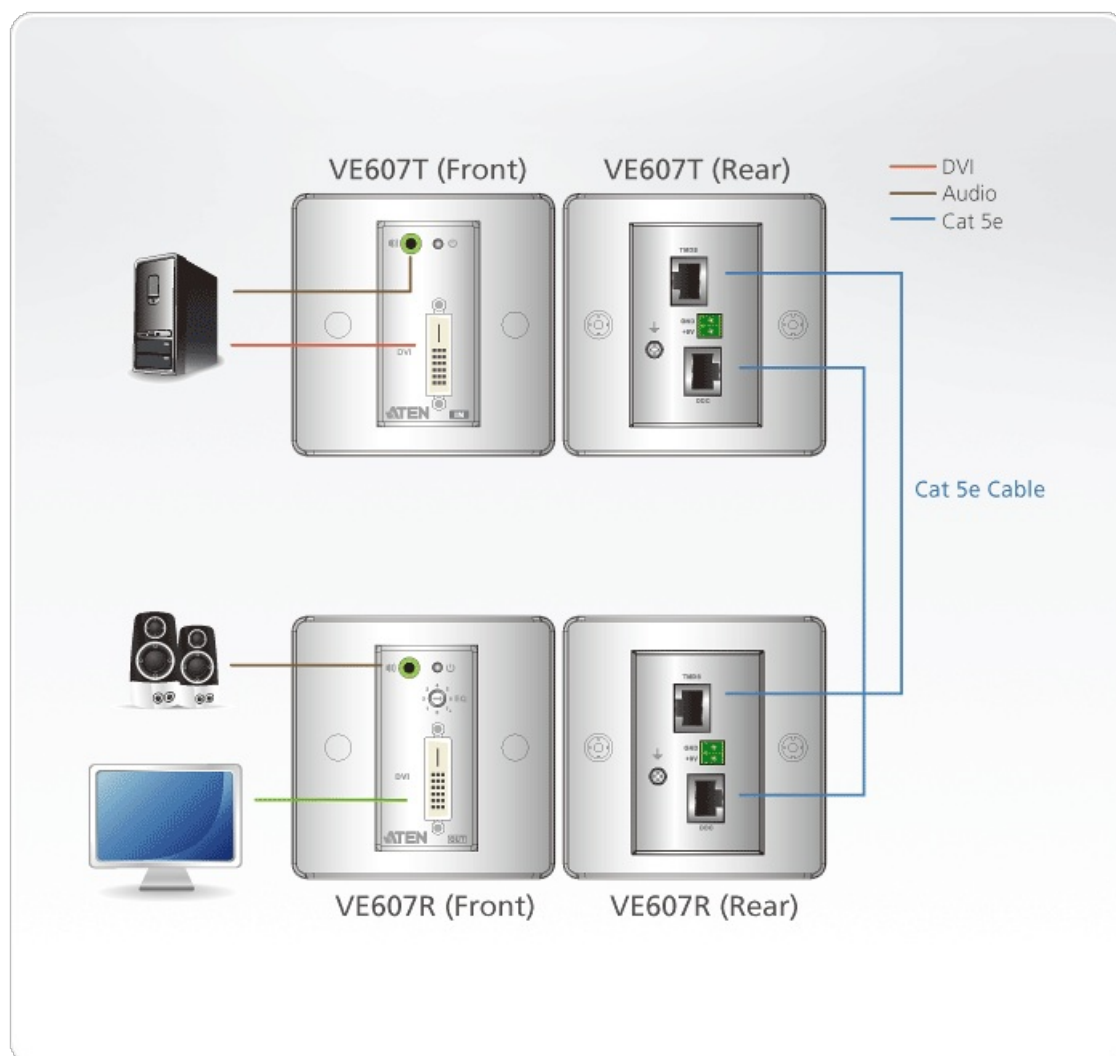

## ATEN International Co., Ltd.

3F., No.125, Sec. 2, Datong Rd., Sijhih District., New Taipei City 221, Taiwan  
 Phone: 886-2-8692-6789 Fax: 886-2-8692-6767  
 www.aten.com E-mail: marketing@aten.com



© Copyright 2015 ATEN® International Co., Ltd.  
 ATEN and the ATEN logo are trademarks of ATEN International Co., Ltd.  
 All rights reserved. All other trademarks are the property of their  
 respective owners.