

VS461

4-Port DVI/Audio Switch



The 4-port VS461 chart a revolutionary new direction in multimedia functionality by combining a Single Link DVI video switch with stereo quality audio. Now you can easily switch between the digital video and audio output of 4 digital devices (such as DVD players or computers), and enjoy it on a single DVI display and set of speakers.

Conveniently switch between DVI input sources using pushbuttons located on the unit's front panel or sit back and use the IR remote control. The VS461 improves upon previous designs by supporting Single Link DVI (Digital Video Interface), providing superior video quality up to 1920 x 1200. DVI supports both digital video input (flat panel displays, data projectors, plasma displays, digital TVs and set-top boxes) and analog video input (traditional monitors and TVs)

Features

- Displays the video output of four digital devices (e.g., DVD player, computer) on a single DVI display device
- Fully compliant with DVI-Digital and DVI-Analog
- Audio-enabled
- Quick and easy switching via front panel pushbuttons or IR remote control
- Superior video quality - up to 1920 x 1200
- Power On Detection – if one DVI source is powered off, the VS461 will automatically switch to the next powered-on source
- Stackable design
- Supports PCs and Macs
- HDCP Compatible

Specifications

Video Input	
Interfaces	4 x DVI-I Female (White)
Impedance	100 Ω
Max. Distance	1.8 m
Video Output	
Interfaces	1 x DVI-I Female (White)
Impedance	100 Ω
Max. Distance	5 m

Video	
Max. Data Rate	6.75 Gbps (2.25 Gbps Per Lane)
Max. Pixel Clock	225 MHz
Compliance	HDCP Compatible
Max. Resolution	Up to 1920 x 1200
Max. Distance	Up to 5 m
Audio	
Input	8 x Stereo RCA Jack Female (Red/White)
Output	2 x Stereo RCA Jack Female (Red/White)
Connectors	
Power	1 x DC Jack
Power Consumption	DC5.3V:1.8W:8BTU/h Note: <ul style="list-style-type: none"> ● The measurement in Watts indicates the typical power consumption of the device with no external loading. ● The measurement in BTU/h indicates the power consumption of the device when it is fully loaded.
Environmental	
Operating Temperature	0 - 50°C
Storage Temperature	-20 - 60°C
Humidity	0 - 80% RH, Non-Condensing
Physical Properties	
Housing	Metal
Weight	0.75 kg (1.65 lb)
Dimensions (L x W x H)	21.00 x 8.80 x 5.55 cm (8.27 x 3.46 x 2.19 in.)
Carton Lot	10 pcs
Note	For some of rack mount products, please note that the standard physical dimensions of WxDxH are expressed using a LxWxH format.

Diagram

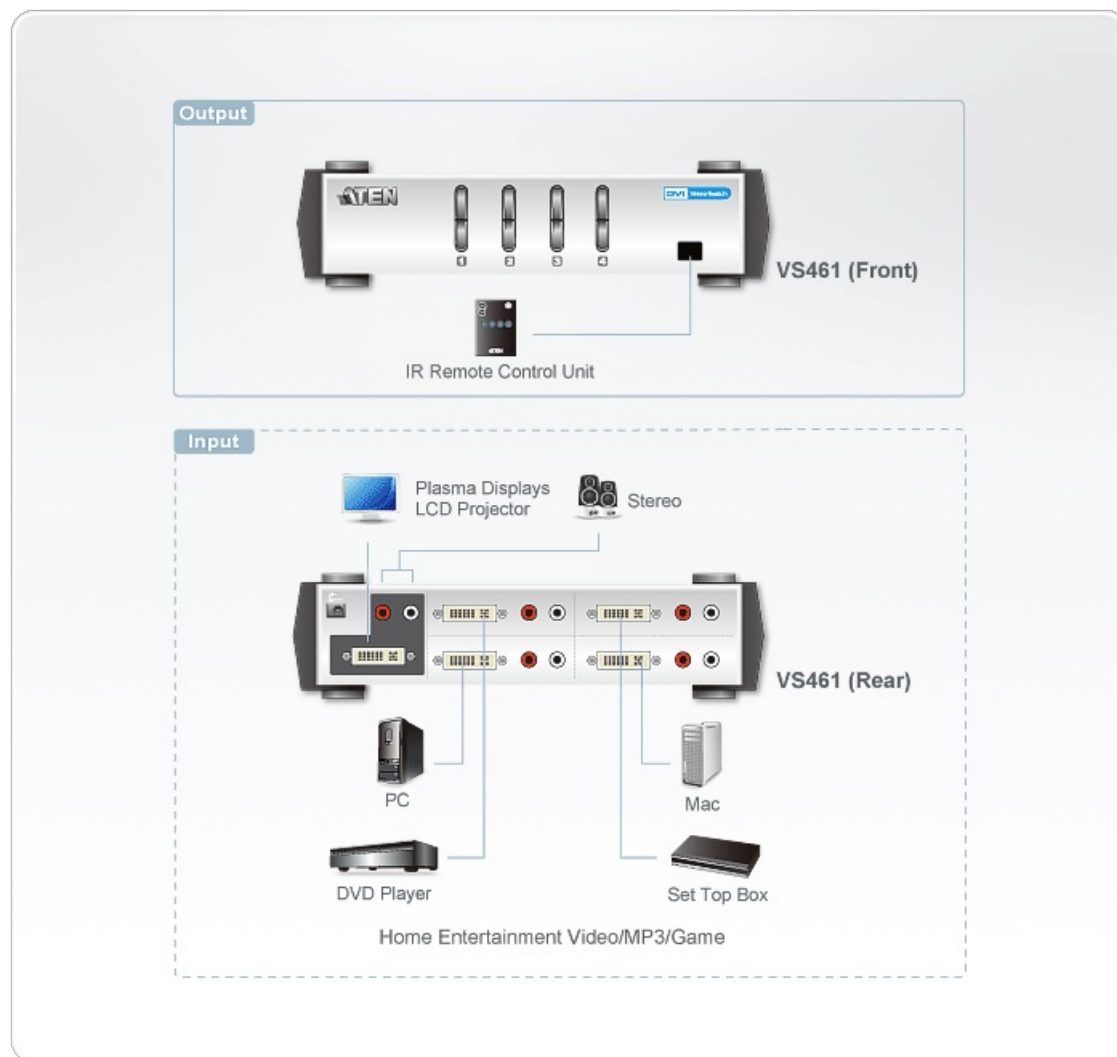

ATEN International Co., Ltd.

3F, No.125, Sec. 2, Datong Rd., Sijhih District., New Taipei City 221, Taiwan

Phone: 886-2-8692-6789 Fax: 886-2-8692-6767

www.aten.com E-mail: marketing@aten.com



© Copyright 2015 ATEN® International Co., Ltd.
 ATEN and the ATEN logo are trademarks of ATEN International Co., Ltd.
 All rights reserved. All other trademarks are the property of their
 respective owners.