

## UC3022

CAMLIVE™ PRO (Dual HDMI to USB-C UVC Video Capture)



## UC3022

CAMLIVE™ PRO | 4K Video Capture / Switch with Wireless Control

Enhance Your Conferencing Experience

Effortless One-person Dual-camera Video Production and Livestreaming



Dual Video  
Capture



Video Switch



Bluetooth Wireless  
Control



Scene Presets

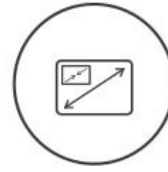

Digital Video  
Effects



Chroma Keyer

## OnAir Lite





#### A Professional One-Person Production Studio

Providing the most fluid video streaming workflow for dual camera / single operator setups, CAMLIVE™ PRO is a video capture and switch device that can turn any professional 4K camera, camcorder, or GoPro into an HDMI video source for a computer or mobile device to stream, coupled with the incredibly feature-rich DVE (Digital Video Effect) options and chroma keyer. Just connect a camera, mic, and laptop, and you are ready to stream and switch between two video inputs.

#### 4K Capture, Stream, and Switch Instantly

CAMLIVE™ Pro is designed to easily connect with two 4K video sources and mix and stream in FHD format to a worldwide audience with outstanding video effects and professional full HD quality. It's completely plug and play and compatible with any streaming software and social media platform, such as Skype, Teams, Zoom, OBS, YouTube, and Facebook. For streamers who want to make interviews, presentations, or even live events, using CAMLIVE™ PRO is easy and fast!







The image displays the ATEN OnAir Lite app interface across multiple devices. In the top left, the ATEN logo is shown above the text "OnAir Lite". Below this, a hand holds a smartphone displaying the app's main control screen. The screen is divided into several sections: a "SCENE" section with eight preset thumbnails (1-8), a "TRANSITION" section with buttons for "Fade", "Cut", and "0.3s", and an "EFFECT" section with "Key", "Auto", and "Blank" options. Above the hand, three other screens are shown, illustrating different app features: a "Scene Name" editor, a "CHROMA KEY" settings screen with "HDMI 1" and "HDMI 2" inputs, and an "AUDIO" settings screen with "HDMI 1" and "HDMI 2" inputs. In the bottom right corner, there are two QR codes for downloading the app from the App Store and Google Play.

#### Free ATEN OnAir Lite Control App with Continuous Updated Features

The ATEN OnAir Lite control app allows for controlling remotely, editing in real-time, chroma keying, and arranging multi-elements into your program mix. You can switch and mix video/audio, change settings and effects, and save up to 8 scene presets for quick switching. Upcoming new features will include command shortcuts for chats, animations, and sound effects, all to help streamline your workflow.

#### Take Control of Your Entire Stream

The app's Remote Deck functionality gives you professional stream control of keyboard shortcuts integration to your smartphone. You can customize up to 18 buttons on app to trigger actions instantly on applications, streaming software or platforms like OBS studio, YouTube, or Twitch. Activate scenes, launch media, interact with fans, and adjust audio, all at your fingertips seamlessly, reducing the need to memorize keyboard shortcuts and instead streamlining workflows.



## Contact Us

Get a quote for this product or get in touch with our sales experts

[Get Quote](#)

[Contact Sales](#)



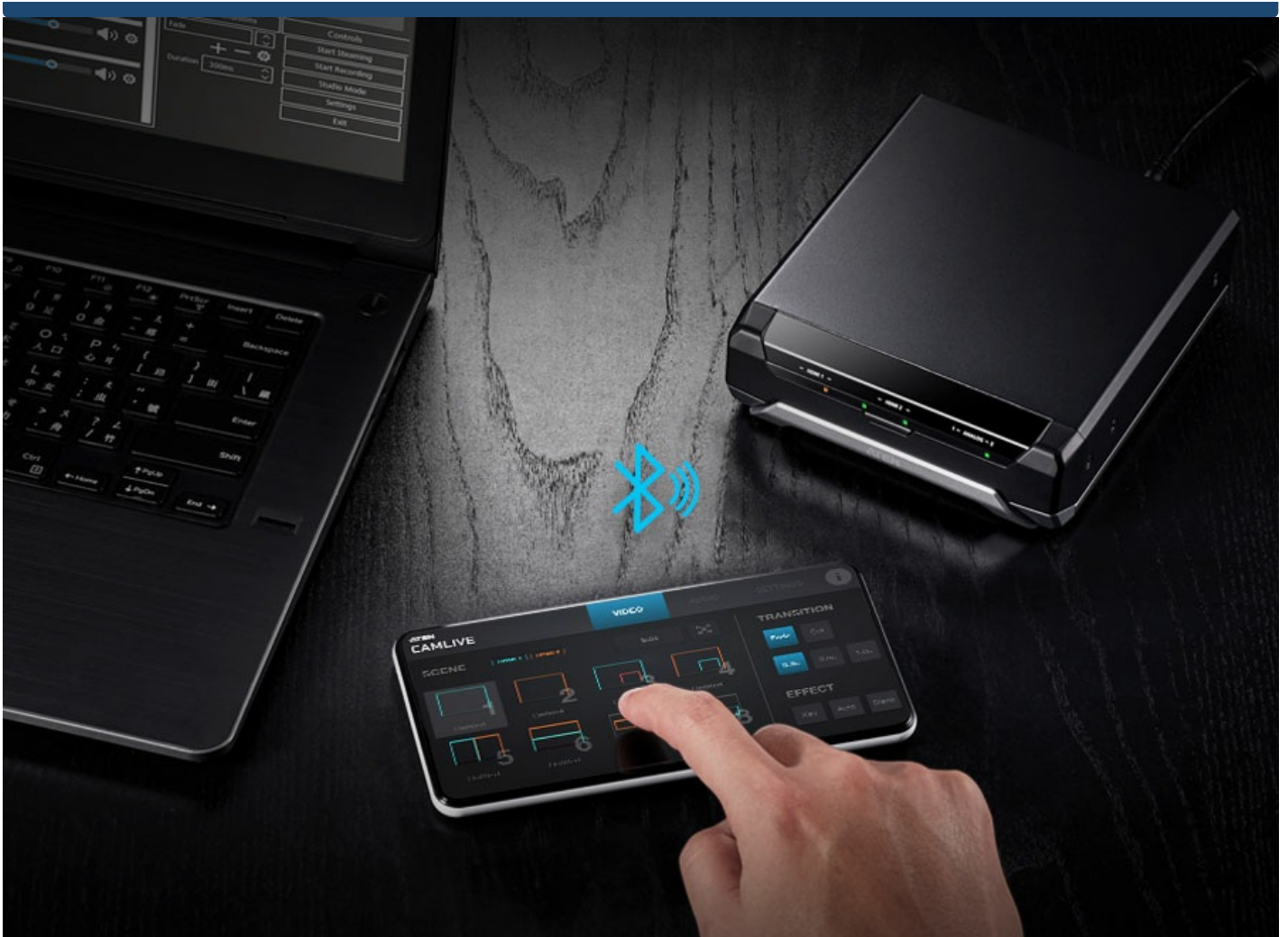

#### Direct Your Livestream Workflow via Bluetooth

You don't need to stay by your equipment or hire a person to help direct your show. Simply use Bluetooth, and the OnAir Lite app, to connect your smartphone to the UC3022. A single user can easily produce pro-level video content with smooth transitions and pro-looking effects, without any production crew required.

#### Make Your Livestreaming Unique with DVE (Digital Video Effect) and Chroma Keyer

The built-in DVE lets you create professional picture-in-picture and picture-by-picture effects with amazing transitions. With 4K resolution input capability, you can even split, crop, or scale images and insert them into different scenes without losing any image quality. The most exciting is using chroma keying with eye-popping effects for a superior finish.

## Video Input: Up to 2160p30



## Video Output: Up to 1080p60

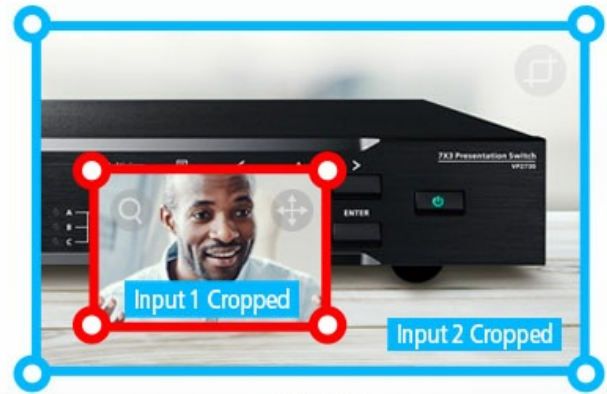

PIP, PBP

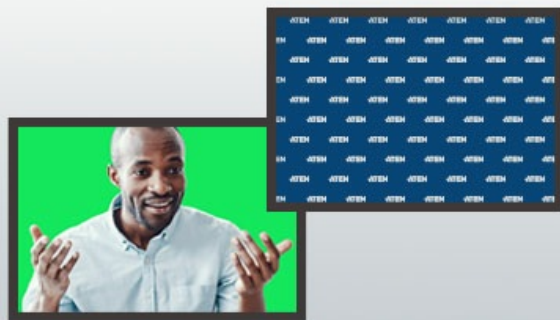

Chroma Keying



**Incredibly Portable and Powerful**

This micro device packs several features in one and its lightweight design makes it possible to fit in any case so you can take it to any live event or production.

**Stream Presentations, Conferences, Lessons, Worship Services, and More!**

CAMLIVE™ PRO is an extremely versatile product that allows you to create pro-level video productions in a wide variety of situations. With it you can stream live video for interviews, corporate conferences / webinars, school lectures, church worship services, or live events, all in full HD quality.



#### Output a Clean Feed from Your iPhone's or iPad's Camera

The free ATEN OnAir Cam App turns your camera into a video production tool for multi-cam livestreaming setups. Stream to livestreaming devices or applications, such as CamLIVE™, StreamLIVE™, OBS Studio, Zoom, and Teams with camera control.\*

\* An HDMI adapter is required to output a clean feed to ATEN CamLIVE™ and StreamLIVE™.

\* An HDMI adapter and a video capture card are required to output a clean feed to a computer.

OnAir Cam

Download on the App Store

CLEAN HDMI VIDEO FEED UP TO 1080P60

CamLIVE™

StreamLIVE™

Computer

Camera control functions:

- Front / Back Camera Switch
- Flashlight On/Off
- Microphone On/Off
- Focus
- Exposure Value

[Talk to Our Experts](#)



If you prefer to have ATEN contact you, please complete the form and a representative will be in touch with you shortly

**4K****USB-C****Resolution  
1080P****Video  
Capture****Video  
Switch****Audio  
Mixer**



## Features

The CAMLIVE™ PRO is designed to capture and mix the two connected 4K video sources in FHD format for live streaming purposes while providing outstanding video effects and remarkable image quality. This video capture device comes with capabilities of video capture, encoding, two-channel video mixing, and content switching from HDMI sources and professional line-level audio devices, making livestreaming production stand out from countless CDN videos. With the CAMLIVE™ PRO, users can easily switch between multiple connected sources and combine them for rich information delivery in streaming. In addition, the device automatically converts the sources to USB video format in 720P or 1080P and sends to the receiving laptop / smartphone via USB port.

The CAMLIVE™ PRO works with the intuitive ATEN OnAir Lite app, which helps place everything you will need to customize the video stream right at your fingertips, as well as allows you to combine, crop, and scale video to make amazing PnP layouts. Users can preset up to eight custom scenes and manage audio sources through the intuitive touch panel interface for a superior pro-level finish. The adoption of chroma key technique enables users to replace the background with another content for eye-popping effects.

Streamlining video streaming workflow for dual-camera or single operator setups, the CAMLIVE™ PRO, with its one-stop programming and streaming functionalities that work on PC / Mac platforms, allows any streamer to broadcast over Internet in high quality to major streaming services or remote conferencing services, such as YouTube Live, Facebook, OBS, Microsoft Teams, Microsoft Mixer, Zoom, CameraFi, and Twitch.

The CAMLIVE™ PRO is a lightweight, easy-to-carry and flexible solution when it comes to content capturing, editing and streaming in versatile independent live streaming events. Get ready to stand out from the crowd of streamers with just the CAMLIVE™ PRO, the ATEN OnAir Lite app and a laptop / smartphone.

- Mix and capture two non-HDCP 4K live videos at 1080P UVC format on PC or mobile device via USB 3.x interface with seamless transition
- Intuitive Android / iOS App control –
  - set up your camera gear and direct your show from anywhere
  - Multi-Crop function with 4K resolution input capability, users can crop multiple images from the connected HDMI inputs, resize and insert them into different scenes
  - Remote Deck function customize up to 18 hotkey buttons to fully control the OBS or other streaming software installed on the host device
- Supports real-time HDMI program video preview
- Easily identifiable chroma keys – allows users to appear anywhere they want by changing the background
- Provides audio mixer with additional dual analog audio inputs
- Supports protected video switching mode for regular event usage
- Compatible with USB & Thunderbolt 3 (USB-C) specification

## Specifications

Connectors	
Video In	2 x HDMI Type A Female (Black)
USB Port	USB 3.2 Gen1 Type-B Male (Blue) (USB-B to USB-C and USB-B to USB-A cable package included)
Video Output	1 x HDMI Type A Female (PGM Video, Black)
Audio Inputs	1x balanced analog audio via XLR connectors 1x unbalanced audio via RCA connectors.
Video Resolution	Video input: 2160p30/25/24, 1080p60/50/30/25/24, 720p60/50, HDMI unencrypted  PGM video out: 1080p60/50/30/25/24, 720p60/50, HDMI unencrypted (Support encrypted PGM output at 2160p30/25/24, 1080p60/50/30/25/24, 720p60/50 with UVC capture disabled)
Audio Sampling	16-bit PCM audio, 44.1KHz and 48KHz
Output	Uncompressed 1080p60 & 720p60 UVC video stream with UAC audio (Uncompressed video stream is only available on USB3.1 connection)
Environmental	
Operating Temperature	0 - 40 °C
Storage Temperature	-20 – 60 °C
Humidity	0 - 80% RH, Non-Condensing
Minimum Hardware Requirements	PC/Mac: CPU: Intel® i3 Dual Core 2.8Ghz or higher RAM: 4GB or more One USB-C interface or USB-A interface  Smartphone: Android device with UVC support and USB-C interface*  *For detail UVC compatible device list, please refer to following info revealed by third party App. <a href="https://www.camerafi.com/supported-devices/">https://www.camerafi.com/supported-devices/</a>
Connection	Bluetooth Low Energy(BLE) technology
OS Support	Windows 10 and above * Mac OS X 10.13 and above Android 5.x and above or iOS 10.1 and above , with Bluetooth 4.2 or higher supporting Bluetooth Low Energy (BLE)  *Window 7 requires driver installation
Physical Properties	
Housing	Metal
Weight	0.68 kg ( 1.5 lb )
Dimensions (L x W x H)	13.00 x 15.18 x 4.25 cm (5.12 x 5.98 x 1.67 in.)
Note	For some of rack mount products, please note that the standard physical dimensions of WxDxH are expressed using a LxWxH format.



Diagram

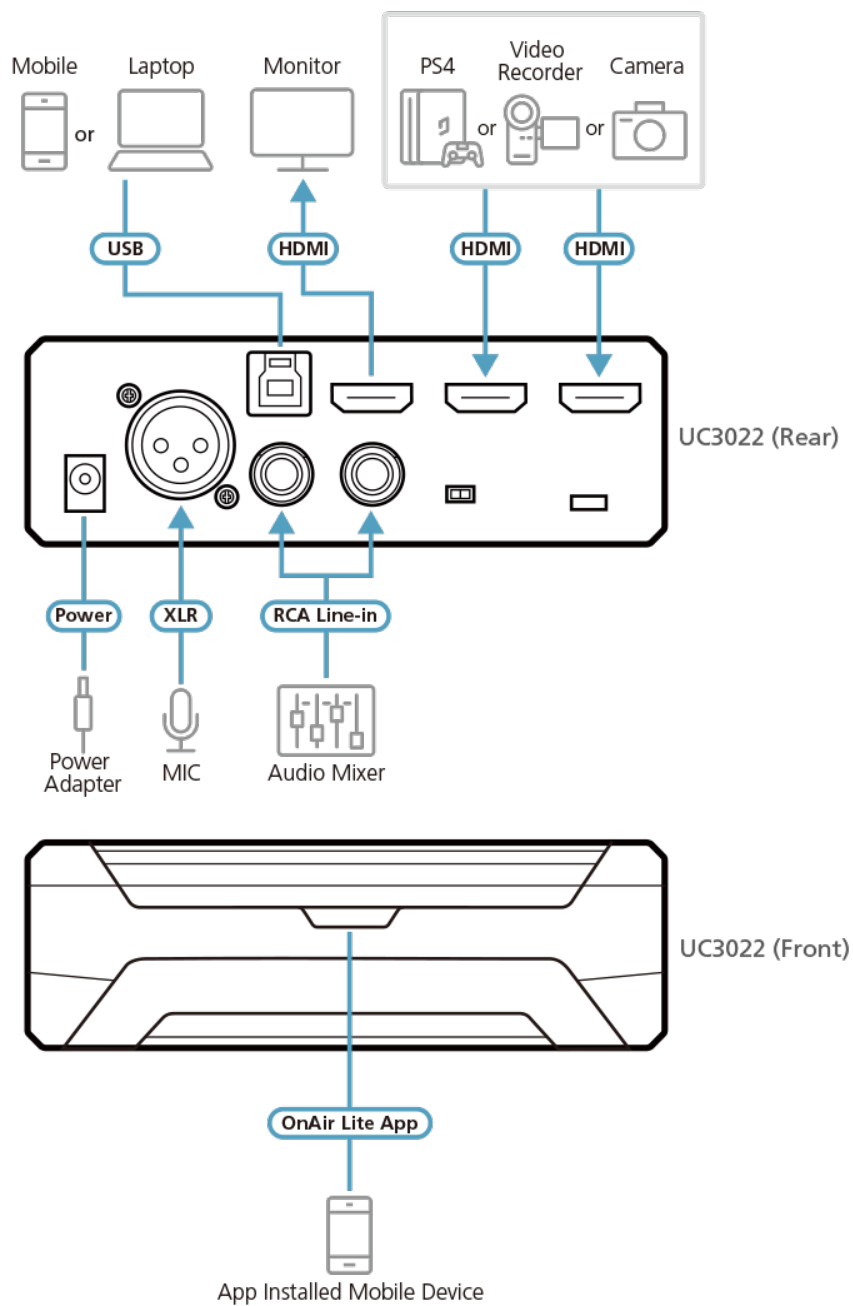

**ATEN International Co., Ltd.**

3F., No.125, Sec. 2, Datong Rd., Sijhih District., New Taipei City 221, Taiwan  
 Phone: 886-2-8692-6789 Fax: 886-2-8692-6767  
 www.aten.com E-mail: marketing@aten.com



© Copyright 2015 ATEN® International Co., Ltd.  
 ATEN and the ATEN logo are trademarks of ATEN International Co., Ltd.  
 All rights reserved. All other trademarks are the property of their respective owners.